

LOC	DIST	REVISIONS			
P	LTN	DESCRIPTION	DATE	DMN	APVD
E		REVISED PER ECO-10-015550	19FEB2011	HMR	JTL
F		REVISED PER ECO-14-000886	20FEB2014	JW	SH
FI		REVISED PER ECO-14-010419	11JUL2014	JW	SH

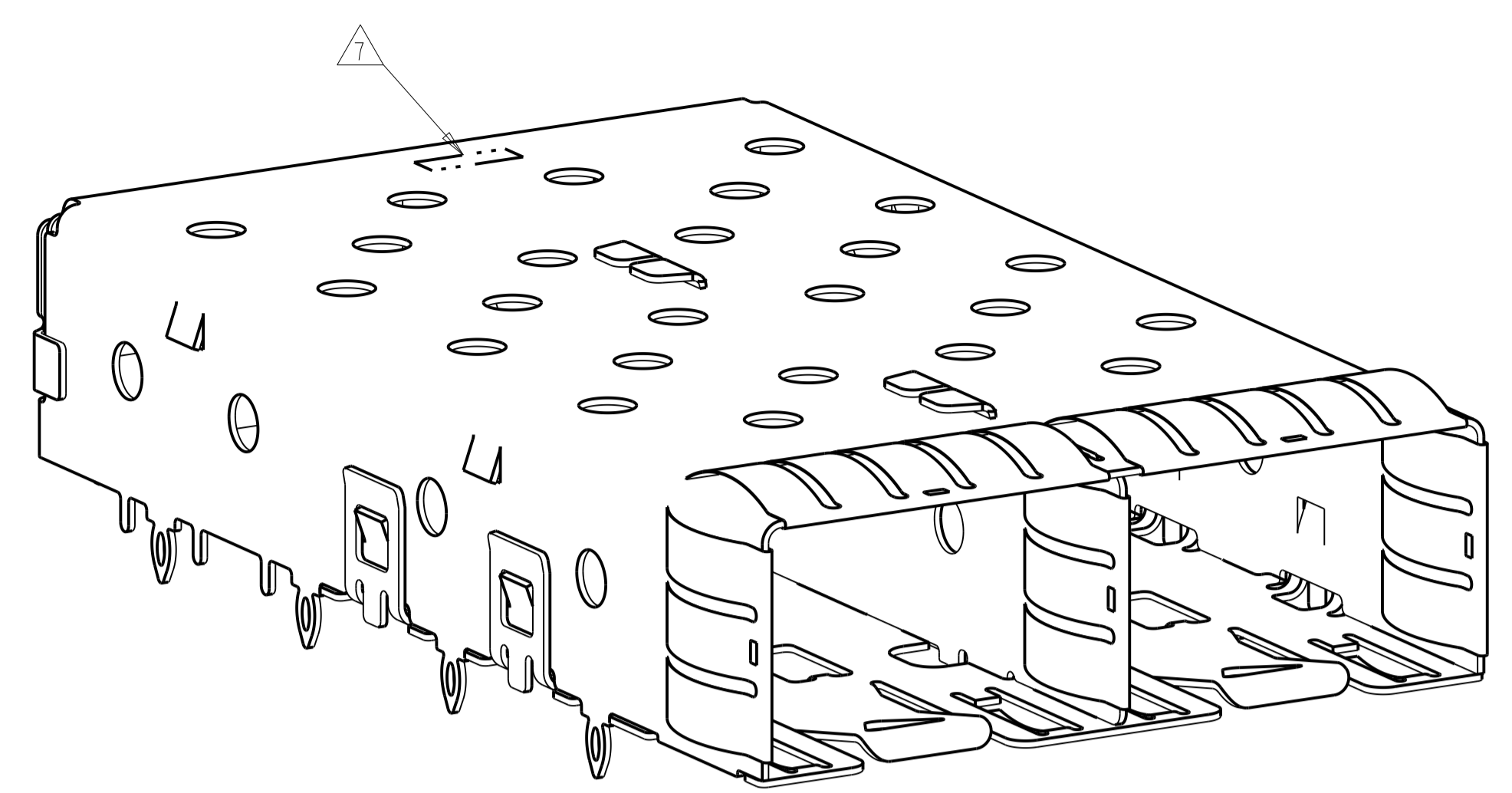

- △ MATERIAL: COPPER ALLOY.
- △ FINISH:
 CAGE: 1.25µm MIN TIN OVER NICKEL FLASH. NON PLATED EDGES PERMISSIBLE.
 SPRINGS: 0.8µm MIN TIN OVER 0.8µm MIN NICKEL. NON PLATED EDGES PERMISSIBLE.
- △ PADS AND VIAS CHASSIS GROUND.
- △ DATUMS AND BASIC DIMENSIONS ESTABLISHED BY CUSTOMERS.
- △ MATES WITH SFP MSA COMPLIANT TRANSCEIVERS.
- △ REFERENCE APPLICATION SPEC 114-13120, HOLE A, FOR RECOMMENDED DRILL HOLE DIAMETER AND PLATING THICKNESSES.
- △ COMPANY LOGO IN APPROXIMATE AREA SHOWN
- △ DATE CODE AND PART NUMBER IN APPROXIMATE AREA SHOWN.
- △ MATERIAL: NICKEL SILVER ALLOY(NO PLATING)

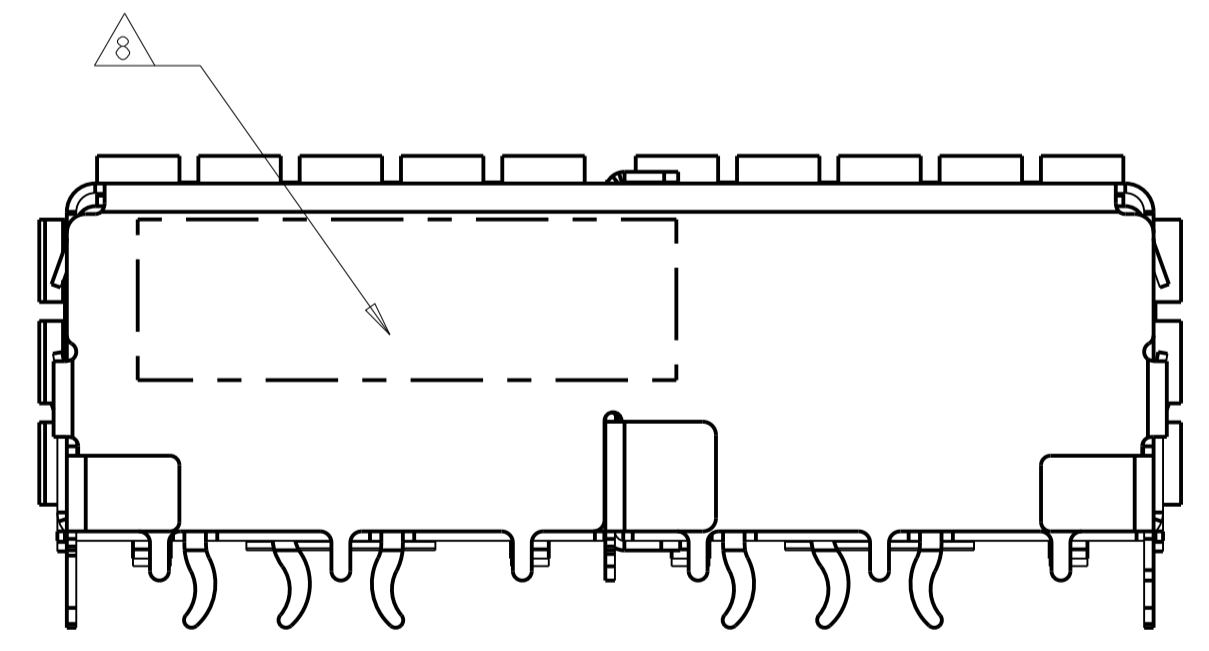
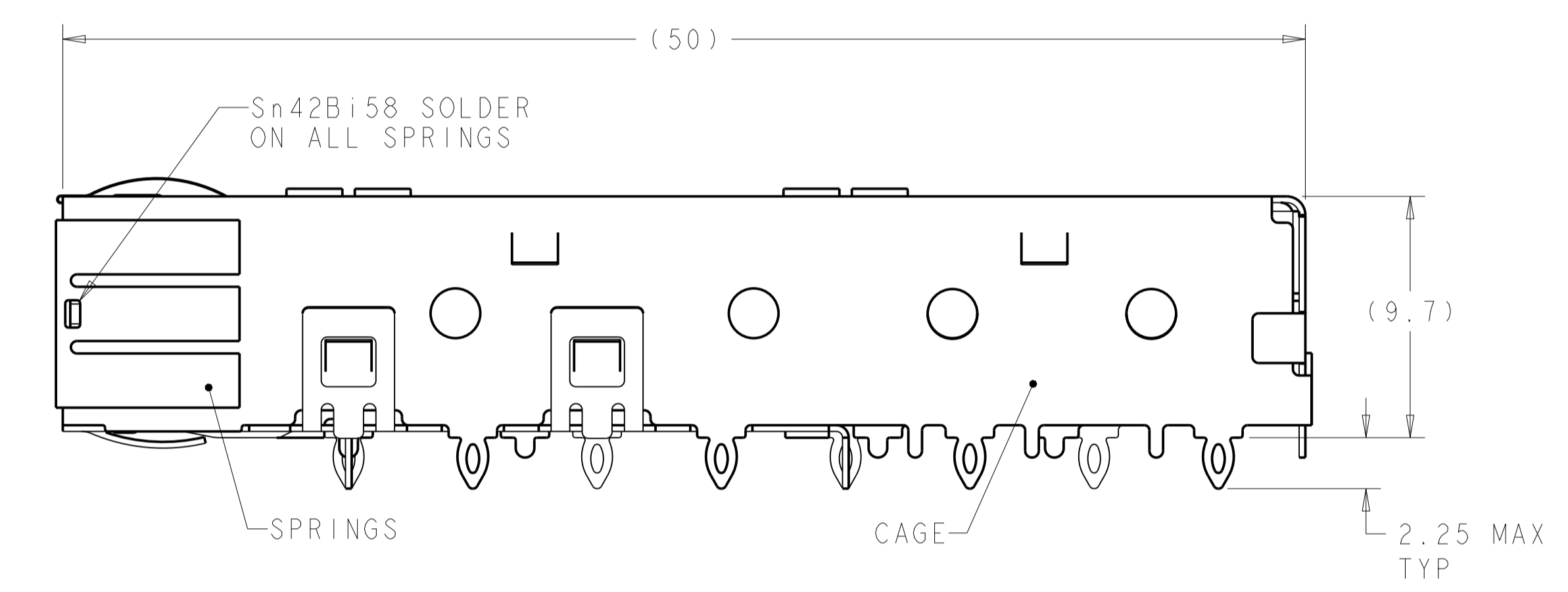
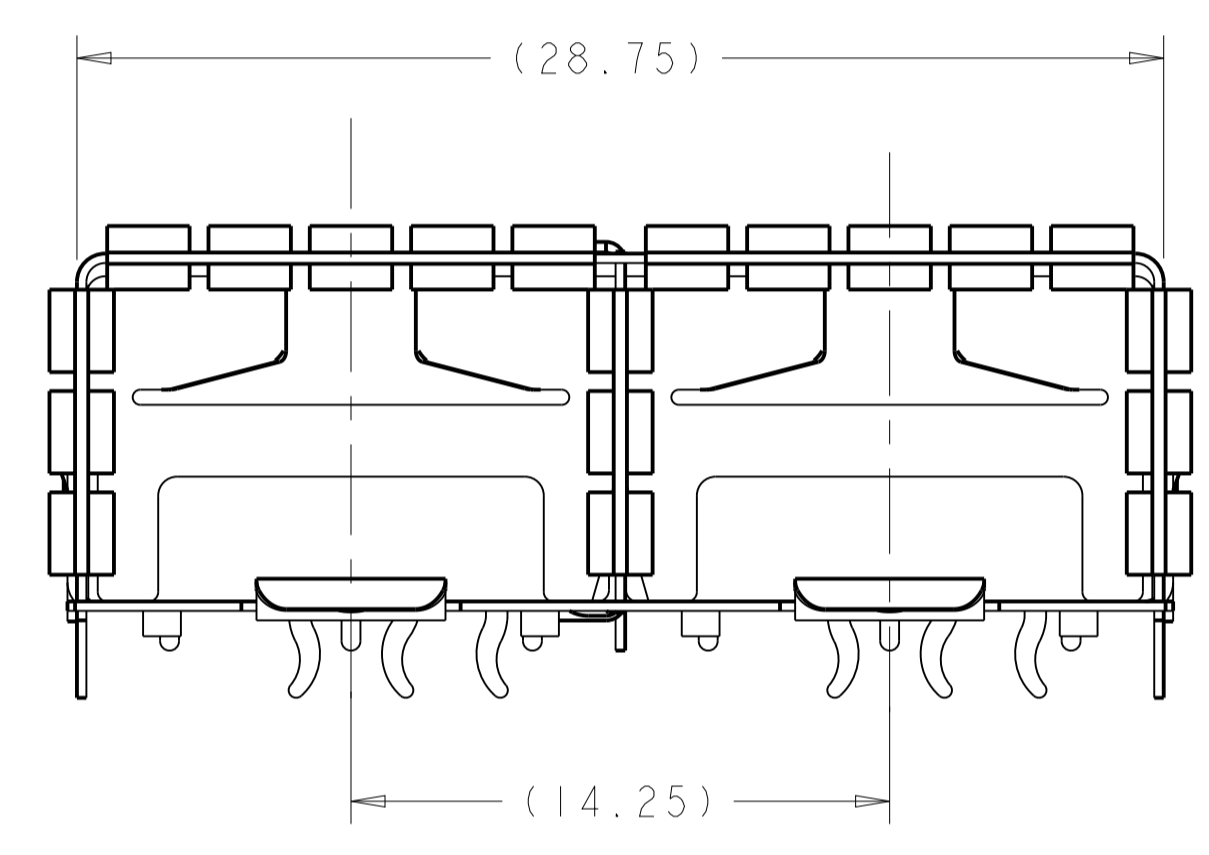
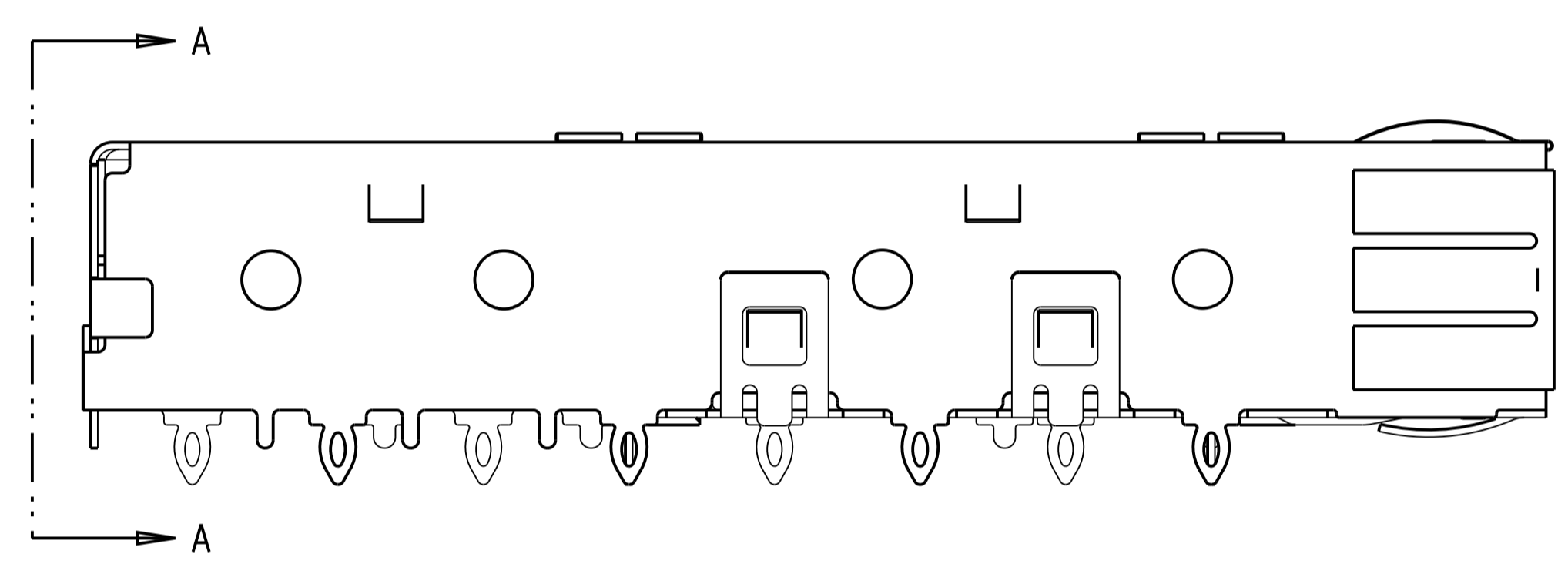

SECTION A-A

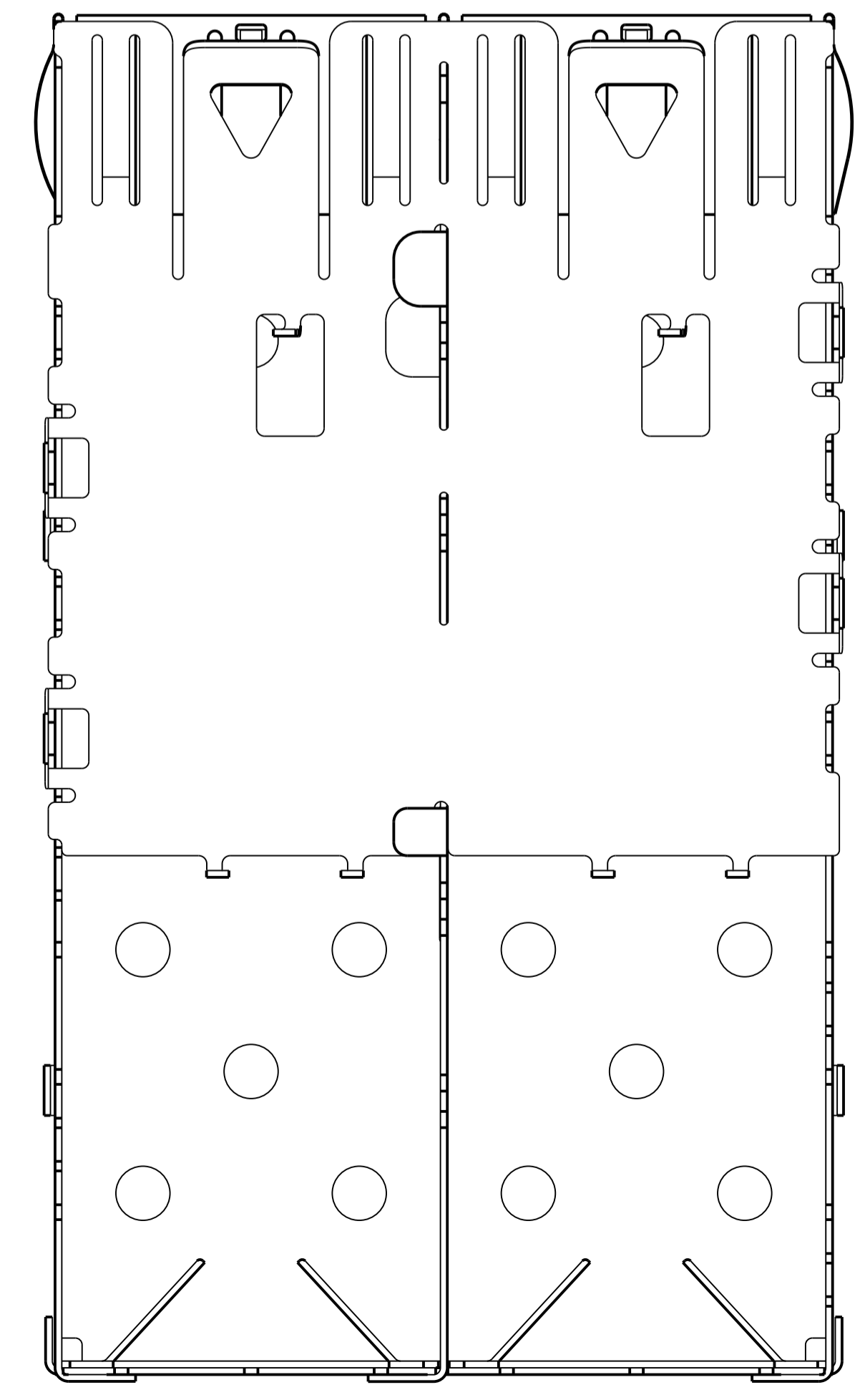

NO	△	0.15	10.15	30.75	29.5	1X2 ASSEMBLY	1888424-2
	△	0.15	10.15	30.75	29.5	1X2 ASSEMBLY	1888424-1
FINISH MATERIAL		D±0.1	C±0.1	B MIN	A±0.1	DESCRIPTION	PART NUMBER

THIS DRAWING IS A CONTROLLED DOCUMENT.		DMN	B. MCMASTER	30NOV06
DIMENSIONS:		CHK	J. KOPPENHEFFER	30NOV06
mm		APVD	J. KOPPENHEFFER	30NOV06
TOLERANCES UNLESS OTHERWISE SPECIFIED:		NAME		
0 PLC	±	SFP ENHANCED EM1		
2 PLC	±0.10	1X2 CAGE ASSEMBLY		
3 PLC	±	PRODUCT SPEC		
4 PLC	±	108-1950		
ANGLES	±2°	APPLICATION SPEC		
MATERIAL		114-13120		
FINISH		WEIGHT		
△		A1		
△		C=1888424		
CUSTOMER DRAWING		SCALE 5:1 SHEET 1 OF 2 REV FI		

